

Ball valves OMAX

Full-port ball valve with nut on stem and aluminium butterfly handle (female-female version)

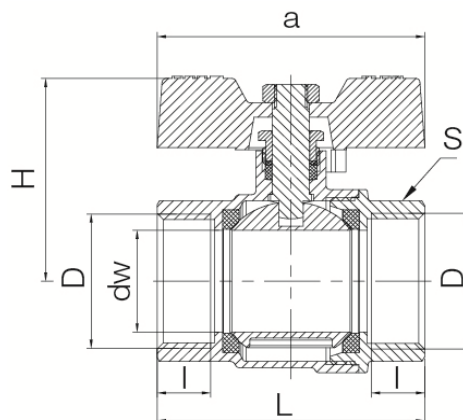

DN	Code	Dimensions								EAN13
		Size	D	I	dw	L	a	H	S	
15	1402220	1/2"	G1/2	12	15	48,5	51,5	37	25	5902273572060
20	1403220	3/4"	G3/4	11	20	56	51,5	40,5	31	5902273572077
25	1404220	1"	G1	13	25	65	65	50	37	5902273572084

Product usage:

Used as shut-off fittings in cold and hot water systems, in central heating systems (including solar systems) where the working medium is water or water / glycol solution (up to 50%)

Type:

Straight ball valves

Technical data/Operating parameters:

Max pressure: 3,0 MPa

Max temperature: 150°C

Guarantee:

25-year

Used materials:

body, nut, ball, stem, adjustable stem nut: brass;
ball and stem seal: PTFE (teflon);
butterfly handle: aluminium alloy

Finish:

body, nut: nickel; ball: chrome