

## Series Conne

## Concealed shower mixer

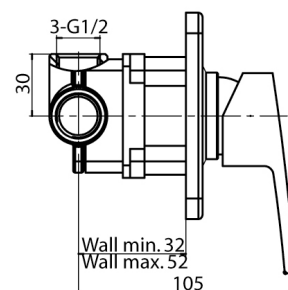
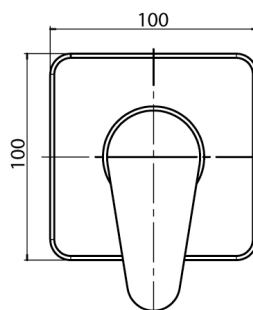

| Code    | Cartridge               | Flow class | Connection | EAN13         |
|---------|-------------------------|------------|------------|---------------|
| 2448960 | cartridge $\Phi$ 35 low | B          | G1/2       | 5907451970850 |

**Product usage:**

For use in with cold and hot water systems in buildings

**Type:**

Shower mixers

**Guarantee:**

25-year

**Technical data/Operating parameters:**

Recommended working pressure: 0,1-0,5 MPa,  
Max temperature: 90°C

**Used materials:**

brass

**Finish:**

chrome