

Ball valves STRIT

Chrome plated angle valve with ceramic head

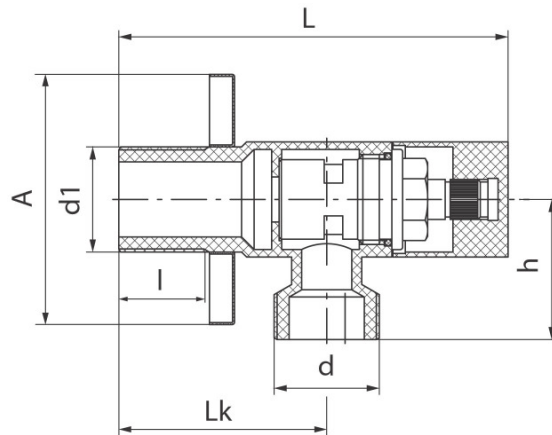

Code	Dimensions								EAN13
	Size	A	L	l	Lk	d	d1	h	
1482870	1/2"-3/8"	50	77,7	18	41,5	G3/8	G1/2	26	5907451933763
1482750	1/2"-1/2"	50	77,7	18	41,5	G1/2	G1/2	28	5907451930106
1483120	1/2"-3/4"	50	84	14	45,5	G3/4	G1/2	29	5907451937693

Product usage:

For use in with cold and hot water systems in buildings

Type:

Angle valves with ceramic head

Guarantee:

25-year

Technical data/Operating parameters:

Max pressure: 1,0 MPa,
Max temperature: 100°C

Used materials:

body, handle, head body, stem: brass;
rosette: stainless steel;
sealing: O-ring seal NBR;
closing element: ceramic plates

Finish:

body, handle: chrome