

**Series EII**

Standing kitchen mixer with side lever with additional aerator MIKADO®

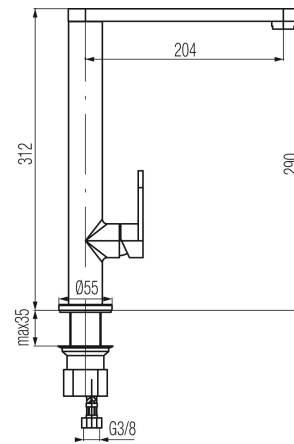

Code	Cartridge	Flow class	Hoses	EAN13
2453727	cartridge $\Phi$ 25	A	G3/8	5902273514664

**Product usage:**

For use in with cold and hot water systems in buildings

**Type:**

Kitchen mixer

**Technical data/Operating parameters**

Recommended working pressure: 0,1-0,5 MPa,

Max temperature: 90°C

Additional aerator -

Limiting flow to 1.9 l / min

**Guarantee:**

25-year

**Used materials:**

brass

**Finish:**

chrome