



VALVEX[™]
Power of Quality

BATHROOMS



SAVE MONEY



MIXER/CERAMIC HEAD



EASY FIX



AERATING STREAM
REGULATOR



EASY CLEAN



ADJUSTABLE DIRECTION
OF WATER FLOW



LOW FLOW



COMFORT ZONE



ROTATIONAL SPOUT



LOCK
DIVERTER



PRESSURE
DIVERTER



CERAMIC
DIVERTER



AUTOMATIC
POP-UP DRAIN



DRAIN ASSEMBLY
WITH PULLING ROD

SAVE MONEY

Save Water & Money.
The faucet aerator with the SAVE MONEY system reduces the flow of water up to 8 l / min., regardless of water pressure.

EASY FIX

EASY FIX is an innovative system for easy installation that is used in single-handle faucets by VALVEX. It significantly reduces the installation time.

EASY CLEAN

The faucet aerator is equipped with EASY-CLEAN technology with an antiscaling system and a rubber finish which makes it resistant to scaling and easy to clean and maintain.

AERATING STREAM REGULATOR

Aerator with adjustable stream direction it allows adjustment of the angle of water outflow in the range of 7 degrees in any direction.

COMFORT ZONE

The high spout creates a comfort zone for the user, ensuring maximum freedom of use of the mixer.

BATHROOMS



That, what surrounds us, reflects your true nature. Feel the inspiration on our everyday life and create a timeless oasis of comfort. Do you desire harmony at your home? Therefore, make sure that your interior is unique, atmospheric and functional, and at the same time it

Enjoy it ...



Discover the
hypnotic

MIKADO 

aerator stream

Turn ordinary handwashing into a delightful experience with the MIKADO Perlator.

Using single water streams, it creates a unique geometric pattern, thanks to which it saves water (flow only 1.9 l / min), without sacrificing your comfort. MIKADO is an innovative aerator that will surely enchant you, and your hands will provide unprecedented sensations: from gently pleasant to energetically massaging.





HARMONY
OF SHAPES

SERIES OF **AURORA**

The unique form of the mixer will give the classic spaces a completely new, expressive face.



Washbasin mixer
with pop-up drain
2445100



EASY INSTALLATION



EASY FIX is an innovative system for easy installation that significantly reduces the installation time.



Washbasin high
mixer
2445110
2445117



Wall mounted
bath mixer
2445130



Wall mounted
shower mixer
2445140



Concealed shower
mixer
2445160



Concealed bathtub
and shower mixer tap
2445170



Bidet mixer with
manual pop-up drain
2445120





UNIQUE
CHARACTER



SERIES OF **AURORA** Rose Gold

An intriguing shape, cleverly smuggled subtle design and color will charm your senses and delight with originality.



DURABLE COATING
The ROSE GOLD coating is created by PVD technology. Its main features are hardness and durability for mechanical damage.

Washbasin mixer
with pop-up drain
2445200



Washbasin high
mixer
2445210
2445217

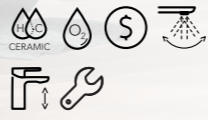

Wall mounted
bath mixer
2445230



Wall mounted
shower mixer
2445240



Concealed shower
mixer
2445260



Concealed bathtub
and shower mixer tap
2445270



Bidet mixer with
manual pop-up drain
2445220





THE BEAUTY
OF GEOMETRY

SERIES OF

QUASAR

A clear line and strong outlines will make the room will acquire a unique character.



Washbasin mixer
with pop-up drain
2446800

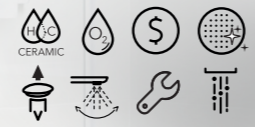

SAVING



LOW-FLOW aerator limiting water consumption up to 4.5 l / min, it's simultaneously environmentally friendly and good for your budget.



Washbasin high
mixer
2446810
2446817



Wall mounted
bath mixer
2446830



Wall mounted
shower mixer
2446840



Concealed shower
mixer
2446860



Concealed bathtub
and shower mixer tap
2446870

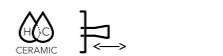

Bidet mixer with
manual pop-up drain
2446820





THE MAGIC OF SYMMETRY

SERIES OF DALI

Slender shapes, without any sharp angles and hard edges, bring to mind the masterpieces of the surrealist painters.



Washbasin mixer with pop-up drain
2447200



ECONOMY

Perlator limiting water consumption to 8 l / min, regardless of the water pressure.



Washbasin high mixer

2447210

2447217



Wall mounted bath mixer

2447230



Wall mounted shower mixer

2447240



Concealed shower mixer

2447260



Concealed bathtub and shower mixer tap

2447270



Bidet mixer with manual pop-up drain

2447220





NOBLE
BLACK



SERIES OF **DALI** Black

The most classic and elegant color combination, constantly present in interior design trends.



Washbasin mixer with pop-up drain
2447900

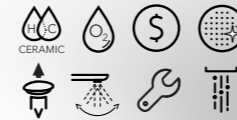

EASY CLEAN

The aerator is equipped with EASY-CLEAN technology with a rubber finish, making it resistant to limescale deposits and easy to clean and maintain.



Washbasin high mixer

2447910
2447917



Wall mounted bath mixer

2447930



Wall mounted shower mixer

2447940



Concealed shower mixer

2447960



Concealed bathtub and shower mixer tap

2447970



Bidet mixer with manual pop-up drain

2447920





MODERN
INTERPRETATION
OF CLASSIC



SERIES OF DALI White

A combination of colors and materials that perfectly harmonize with modern design.



Washbasin mixer
with pop-up drain
2447300

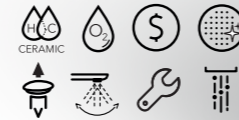

CLICK-CLACK SYSTEM

Click-clack system is a convenient opening and closing of the outflow without having to pull out the whole plug or use additional mechanisms.



Washbasin high mixer

2447310
2447317

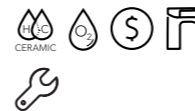

Wall mounted bath mixer

2447330



Wall mounted shower mixer

2447340



Concealed shower mixer

2447360



Concealed bathtub and shower mixer tap

2447370



Bidet mixer with manual pop-up drain

2447320





SERIES OF VEGANE

AURA
OF HARMONY

A perfect combination of design, functionality, energy efficiency and exceptional durability.



Washbasin mixer with manual pop-up drain

2422750



Washbasin high mixer

2422770



Wall mounted bath mixer

2422890



Wall mounted shower mixer

2422870



Bidet mixer with manual pop-up drain

2422850



FUNCTIONALITY
Drain assembly with pulling rod is equipped with a mechanism that allows opening and closing the drain without the need to dip your hands in water.



SERIES OF VEGANE

MODERN
DESIGN

An ideal proposition for people who are attached to tradition, while keeping up with trends.



Wall mounted three-hole washbasin mixer

2422810



SMOOTH ADJUSTMENT



High-quality ceramic heads enable smooth and precise regulation of water flow. Everything is under control, in full harmony ...



Three hole washbasin mixer with manual pop-up drain

2422790



Five hole bath mixer with accessories

2422830





SERIES OF **VEGANE** Nero

BLACK
LUXURY

Deep, dull black closed in a fresh, minimalistic form of the mixer.



Washbasin mixer with pop-up drain

2423310



ECOLOGY



The economical aerator is equipped with a mechanism that mixes the outgoing water with the air. This simple solution gives noticeable savings in consumption, which reach up to 50%.



Washbasin high mixer

2423330

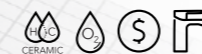

Wall mounted bath mixer

2423390



Wall mounted shower mixer

2423370



Bidet mixer with manual pop-up drain

2423350



SERIES OF **VEGANE** Bianco

GRACE
OF COLOR

Perfectly fits with the colors,
intriguing with the matt, structural
coating. Precision in every inch.

Washbasin mixer
with pop-up drain

2423300



DESIGN

The simple form gives rhythm and provides harmony
while the white finish of the mixer soothes the senses.



Washbasin high
mixer

2423320

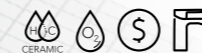

Wall mounted
bath mixer

2423380



Wall mounted
shower mixer

2423360



Bidet mixer with
manual pop-up drain

2423340





POWER OF
POSSIBILITIES

SERIES OF LOFT

Smooth lines, simple and geometric shapes, chrome finish and attention to every detail.



LOFT ECO

Washbasin mixer with pop-up drain

2454900



EASY CLEAN

Just wipe the rubber finish with your finger to eliminate the dirt. Aerator with EASY CLEAN system provides an even stream of water without any splashes and retains its full efficiency for longer.



Washbasin mixer

2454910



Washbasin high mixer (239 mm)

2454920



Washbasin high mixer (270 mm)

2454730

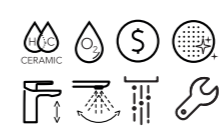

Concealed wall-mounted basin mixer

2454780

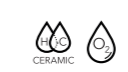

Wall mounted bath mixer

2454930



Wall mounted shower mixer

2454940





MODERN
FUNCTIONALITY

SERIES OF **LOFT**

Smooth lines, simple and geometric shapes, chrome finish and attention to every detail.

DESIGN

The 4-hole bath mixer is practical and convenient to use. Separately mounted: spout, shower head, handle and switch perfectly fit into modern arrangements.

Four hole bath mixer with accessories

2454890



Wall mounted shower mixer with upper connection

2455760



Concealed shower mixer

2454970



Concealed bathtub and shower mixer tap

2454980



3-function concealed mixer

2408660



Bidet mixer with manual pop-up drain

2454950



COMING
SOON



COMPLETE
CHARACTER

The unusual structural coat of the mixer catches the eye, making the interior unique.

FUNCTIONALITY



Adjustable direction of water flow ensures precise adaptation of the flow to your own needs, which is important especially for large washbasins.

Washbasin mixer with pop-up drain

2455900



SERIES OF **LOFT** Black

DESIGN

The individual elements of the mixer, connected with each other in an invisible way to the user, create an impressive bathroom decoration. The swivel spout and retractable shower hose ensure full freedom of movement during bathing.

Four hole bath mixer with accessories

2455950



Washbasin high mixer

2455910



Wall mounted bath mixer

2455920



Wall mounted shower mixer

2455930



Concealed shower mixer

2455960



Concealed bathtub and shower mixer tap

2455970



Bidet mixer with manual pop-up drain

2455940



COMING
SOON



TIMELESS
WHITE

Universal, timeless white,
economical style, moderation.
Classy mixers.

SAVING



Aerator limiting water
consumption to 8 l / min,
regardless of water
pressure.

Washbasin mixer
with pop-up drain

2456500



SERIES OF **LOFT** White

SMOOTH REGULATION



The high-class ceramic head enables smooth and precise water flow regulation. Everything is under control, in full harmony ...

Four hole bath mixer
with accessories

2456550



Washbasin high
mixer

2456510



Wall mounted
bath mixer

2456520



Wall mounted
shower mixer

2456530



Concealed shower
mixer

2456560



Concealed bathtub
and shower mixer tap

2456570



Bidet mixer with
manual pop-up drain

2456540





GREAT VIBE

SERIES OF **LOFT Gold**

A composition full of splendor will delight anyone who will have the pleasure of meeting it ...



Washbasin mixer with pop-up drain
2455800



Wall mounted bath mixer
2455810



Wall mounted shower mixer
2455820



SAVING

The LOW-FLOW aerator, which reduces water consumption by up to 4.5 l / min, is environmentally friendly and good for your wallet.

DURABLE COATING

The GOLD coating is created by PVD technology. Its main features are hardness and resistance to mechanical damage.



SERIES OF TUBE

INSPIRE
BY NATURE

Symphony of shapes emerges
in the form of a subtle, but
decisive form.



TUBE ECO

Washbasin mixer
with pop-up drain

2454800



Washbasin mixer
with pop-up drain

2454810



Washbasin high
mixer

2454820



Wall mounted
bath mixer

2454830



Wall mounted
shower mixer

2454840



Wall mounted shower
mixer with upper conection

2455720



FUNCTIONALITY

The movable disc of the aerator makes it possible
to adjust the angle of the stream to the dimen-
sions of the basin.



SUBTLETY
OF SHAPES

SERIES OF
TUBE

The perfection of the solids is combined with the perfection of action.

ECOLOGY



The economical aerator is equipped with a mechanism that mixes the outgoing water with the air. This simple solution gives noticeable savings in consumption, which reach up to 50%.



Concealed wall-mounted basin mixer

2454790



Concealed shower mixer

2454970



Concealed bathtub and shower mixer tap

2454980



3-function concealed mixer

2408640



Bidet mixer with manual pop-up drain

2454950



SERIES OF SIGMA

ENERGY
THAT DELIGHT

Captivating, endearing, energetic ... Full functionality closed in perfect form.



Washbasin mixer
with pop-up drain

2456100

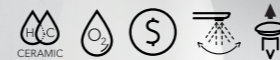

CLICK-CLACK SYSTEM

Click-clack system is a convenient opening and closing of the outflow without having to pull out the whole plug or use additional mechanisms.



Washbasin high
mixer

2456140



Wall mounted
bath mixer

2456110



Wall mounted
shower mixer

2456120



Concealed shower
mixer

2456160



Concealed bathtub
and shower mixer tap

2456160





THE ART
OF COMFORT

SERIES OF **LORI**

Born from a pure love of beauty and functional solutions ...
An interesting mix of classics with a bit of madness.



Washbasin mixer
with pop-up drain

2456200

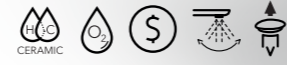

Washbasin high
mixer

2456240

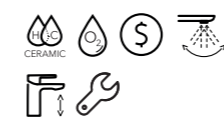

Wall mounted
bath mixer

2456210



Wall mounted
shower mixer

2456220



Concealed shower
mixer

2456250



Concealed bathtub
and shower mixer tap

2456260



ECOLOGY

Save water and money - the aerator with the SAVE MONEY system reduces water flow up to 8 l / min. regardless of water pressure.



EXCEPTIONAL
EVERYDAY

SERIES OF ANGELO

Simple and solid construction, ensuring trouble-free operation for many years. An excellent choice for lovers of convenience and minimalist solutions.



Washbasin mixer with manual pop-up drain
2453000



FUNCTIONALITY



Drain assembly with pulling rod is equipped with a mechanism that allows opening and closing the drain without the need to dip your hands in water.



Wall mounted bath mixer
2453010



Wall mounted shower mixer
2453020



Bidet mixer with manual pop-up drain
2453050



Concealed shower mixer
2453260



Concealed bathtub and shower mixer tap
2453270





UNLIMITED
EXPERIENCE

SERIES OF ESTILL

The FIXED TEMPERATURE system protects us against sudden changes of water temperature. This small, great solution makes your showering an unforgettable and uninterrupted experience.

SAFETY



The innovative COLD TOUCH system ensures that the robust brass body of the spray faucet always remains cool and safe.

Thermostatic mixer
for shower
2447170



Thermostatic mixer
for shower
2447150



Thermostatic mixer
for bathtub
2447160

ECO & SAVING

When using the ESTILL thermostatic mixer, you do not waste time setting the right temperature. You do not lose any more liters of water, or the next kilowatts used to heat too hot water.

TECHNICAL DATA

AURORA



Washbasin mixer

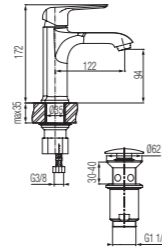

| | | |
|--------------------|---------|---------|
| Code: Chrome | 2445100 | 2445101 |
| Code: Rose Gold | 2445200 | 2445201 |
| Cartridge | Ø35 | |
| Flow class | Z | |
| Hoses / Connection | G 3/8 | G 1/2 |
| Net weight | 1142 g | |

AURORA



Washbasin high mixer

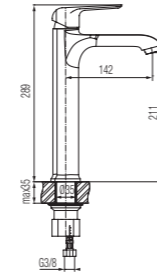

| | | | |
|-----------------|---------|---------|---------|
| Code: Chrome | 2445110 | 2445111 | 2445117 |
| Code: Rose Gold | 2445210 | 2445211 | 2445217 |
| Cartridge | Ø35 | | |
| Flow class | Z | | |
| Hoses/conn. | G 3/8 | G 1/2 | G 3/8 |
| Net weight | 1815 g | | |

QUASAR



Washbasin high mixer

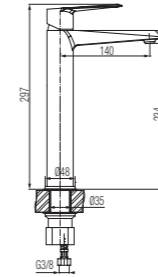

| | | | |
|-------------|---------|---------|---------|
| Code | 2446810 | 2446811 | 2446817 |
| Cartridge | Ø35 | | |
| Flow class | Z | | |
| Hoses/Conn. | G 3/8 | G 1/2 | G 3/8 |
| Net weight | 1640 g | | |
| Finish | Chrome | | |

QUASAR



Bidet mixer

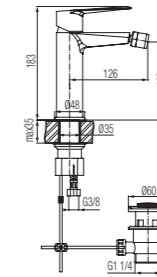

| | | |
|--------------------|---------|---------|
| Code | 2446820 | 2446821 |
| Cartridge | Ø35 | |
| Flow class | A | |
| Hoses / Connection | G 3/8 | G 1/2 |
| Net weight | 1276 g | |
| Finish | Chrome | |

QUASAR



Wall mounted bath mixer

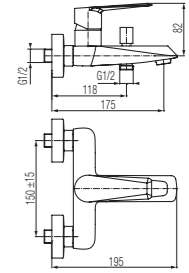

| | |
|--------------------|---------|
| Code | 2446830 |
| Cartridge | Ø35 |
| Flow class | B/B |
| Hoses / Connection | G 1/2 |
| Net weight | 1296 g |
| Finish | Chrome |

AURORA



Bidet mixer

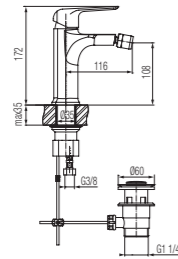

| | | |
|--------------------|---------|---------|
| Code: Chrome | 2445120 | 2445121 |
| Code: Rose Gold | 2445220 | 2445221 |
| Cartridge | Ø35 | |
| Flow class | A | |
| Hoses / Connection | G 3/8 | G 1/2 |
| Net weight | 1289 g | |

AURORA



Wall mounted bath mixer

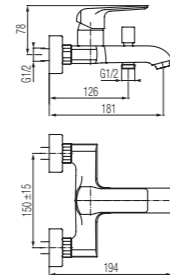

| | |
|--------------------|---------|
| Code: Chrome | 2445130 |
| Code: Rose Gold | 2445230 |
| Cartridge | Ø35 |
| Flow class | B/B |
| Hoses / Connection | G 1/2 |
| Net weight | 1318 g |

AURORA



Wall mounted shower mixer

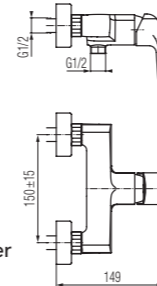

| | |
|--------------------|---------|
| Code: Chrome | 2445140 |
| Code: Rose Gold | 2445240 |
| Cartridge | Ø35 |
| Flow class | B |
| Hoses / Connection | G 1/2 |
| Net weight | 1238 g |

QUASAR



Wall mounted shower mixer

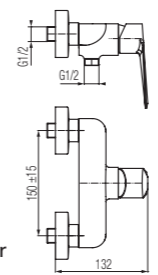

| | |
|--------------------|---------|
| Code | 2446840 |
| Cartridge | Ø35 |
| Flow class | B |
| Hoses / Connection | G 1/2 |
| Net weight | 1265 g |
| Finish | Chrome |

QUASAR



Concealed shower mixer

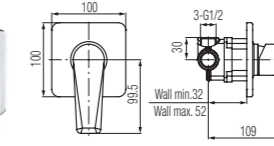

| | |
|--------------------|---------|
| Code | 2446860 |
| Cartridge | Ø35 |
| Flow class | B |
| Hoses / Connection | 3-G 1/2 |
| Net weight | 947 g |
| Finish | Chrome |

QUASAR



Concealed bathtub and shower mixer tap

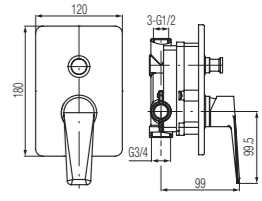

| | |
|--------------------|----------------------------------|
| Code | 2446870 |
| Cartridge | Ø35 |
| Flow class | B/B |
| Hoses / Connection | in 2-G 1/2, out 1-G 1/2, 1-G 3/4 |
| Net weight | 1447 g |
| Finish | Chrome |

AURORA

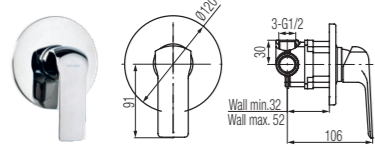

Concealed shower mixer

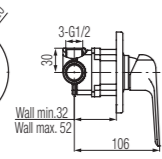

| | |
|--------------------|---------|
| Code: Chrome | 2445160 |
| Code: Rose Gold | 2445260 |
| Cartridge | Ø35 |
| Flow class | B |
| Hoses / Connection | 3-G 1/2 |
| Net weight | 947 g |

AURORA



Concealed bathtub and shower mixer tap

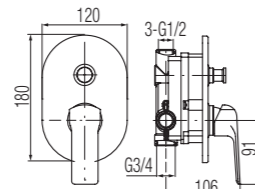

| | |
|--------------------|----------------------------------|
| Code: Chrome | 2445170 |
| Code: Rose Gold | 2445270 |
| Cartridge | Ø35 |
| Flow class | B/B |
| Hoses / Connection | in 2-G 1/2, out 1-G 1/2, 1-G 3/4 |
| Net weight | 1447 g |

QUASAR



Washbasin mixer

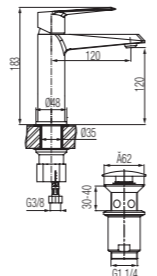

| | | |
|--------------------|---------|---------|
| Code | 2446800 | 2446801 |
| Cartridge | Ø35 | |
| Flow class | Z | |
| Hoses / Connection | G 3/8 | G 1/2 |
| Net weight | 1095 g | |
| Finish | Chrome | |

DALI



Washbasin mixer

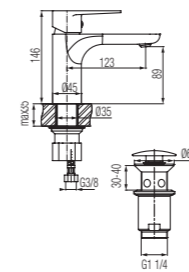

| | | |
|----------------------|---------|---------|
| Code: Chrome | 2447200 | 2447201 |
| Code: White / Chrome | 2447300 | 2447301 |
| Code: Black / Chrome | 2447900 | 2447901 |
| Cartridge | Ø35 | |
| Flow class | Z | |
| Hoses / Connection | G 3/8 | G 1/2 |
| Net weight | 1291 g | |

DALI



Washbasin high mixer

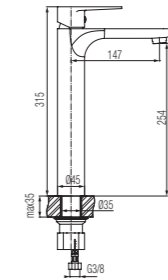

| | | | |
|--------------------|---------|---------|---------|
| Code: Chrome | 2447210 | 2447211 | 2447217 |
| Code: White/Chrome | 2447310 | 2447311 | 2447317 |
| Code: Black/Chrome | 2447910 | 2447911 | 2447917 |
| Cartridge | Ø35 | | |
| Flow class | Z | | |
| Hoses / Connection | G 3/8 | G 3/8 | G 1/2 |
| Net weight | 1699 g | | |

DALI



Bidet mixer

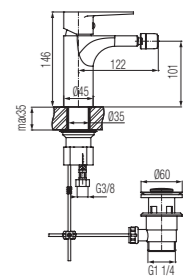

| | | |
|----------------------|---------|---------|
| Code: Chrome | 2447220 | 2447221 |
| Code: White / Chrome | 2447320 | 2447321 |
| Code: Black / Chrome | 2447920 | 2447921 |
| Cartridge | Ø35 | |
| Flow class | A | |
| Hoses / Connection | G 3/8 | G 1/2 |
| Net weight | 1366 g | |

DALI

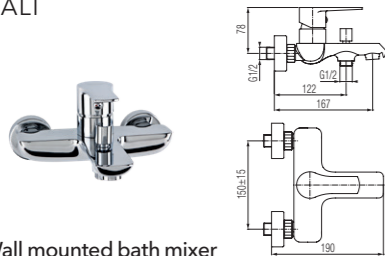

Wall mounted bath mixer

| | |
|----------------------|---------|
| Code: Chrome | 2447230 |
| Code: White / Chrome | 2447330 |
| Code: Black / Chrome | 2447930 |
| Cartridge | Ø35 |
| Flow class | B/B |
| Hoses / Connection | G 1/2 |
| Net weight | 1570 g |

DALI



Wall mounted shower mixer

| | |
|----------------------|---------|
| Code: Chrome | 2447240 |
| Code: White / Chrome | 2447340 |
| Code: Black / Chrome | 2447940 |
| Cartridge | Ø35 |
| Flow class | B |
| Hoses / Connection | G 1/2 |
| Net weight | 1278 g |

DALI

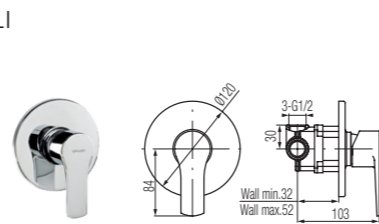

Concealed shower mixer

| | |
|----------------------|---------|
| Code: Chrome | 2447260 |
| Code: White / Chrome | 2447360 |
| Code: Black / Chrome | 2447960 |
| Cartridge | Ø35 |
| Flow class | B |
| Hoses / Connection | 3-G 1/2 |
| Net weight | 947 g |

DALI

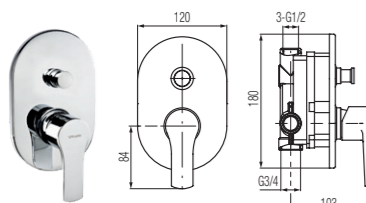

Concealed bathtub and shower mixer tap

| | |
|--------------------|--------------------------------|
| Code: Chrome | 2447270 |
| Code: White/Chrome | 2447370 |
| Code: Black/Chrome | 2447970 |
| Cartridge | Ø35 |
| Flow class | B/B |
| Hoses / Connection | in 2-G 1/2, out 1-G1/2, 1-G3/4 |
| Net weight | 1447 g |

VEGANE

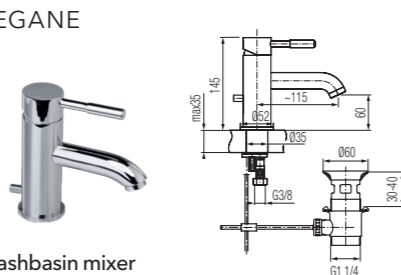

Washbasin mixer

| | | |
|--------------------|---------|---------|
| Code: Chrome | 2422750 | 2422650 |
| Code: Bianco | 2423300 | 2423700 |
| Code: Nero | 2423310 | 2423710 |
| Cartridge | Ø35 | |
| Flow class | Z | |
| Hoses / Connection | G 3/8 | G 1/2 |
| Net weight | 1697 g | |

VEGANE

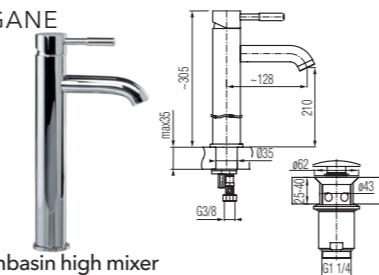

Washbasin high mixer

| | | |
|--------------------|---------|---------|
| Code: Chrome | 2422770 | 2422660 |
| Code: Bianco | 2423320 | 2423720 |
| Code: Nero | 2423330 | 2423730 |
| Cartridge | Ø35 | |
| Flow class | Z | |
| Hoses / Connection | G 3/8 | G 1/2 |
| Net weight | 2365 g | |

VEGANE

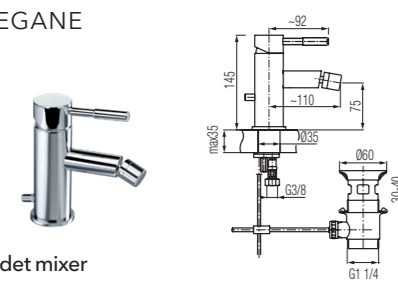

Bidet mixer

| | | |
|--------------------|---------|---------|
| Code: Chrome | 2422850 | 2422670 |
| Code: Bianco | 2423340 | 2423740 |
| Code: Nero | 2423350 | 2423750 |
| Cartridge | Ø35 | |
| Flow class | A | |
| Hoses / Connection | G 3/8 | G 1/2 |
| Net weight | 1628 g | |

VEGANE

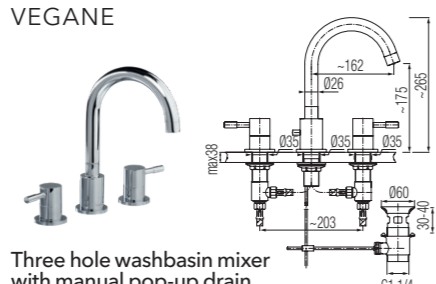

Three hole washbasin mixer with manual pop-up drain

| | |
|--------------------|--------------------|
| Code: Chrome | 2422790 |
| Cartridge | głowica ceramiczna |
| Flow class | A |
| Hoses / Connection | G3/8 |
| Net weight | 3133 g |

VEGANE

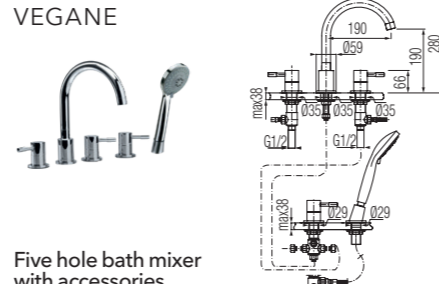

Five hole bath mixer with accessories

| | |
|--------------------|--------------------|
| Code: Chrome | 2422830 |
| Cartridge | głowica ceramiczna |
| Flow class | B/A |
| Hoses / Connection | G3/8 |
| Net weight | 4399 g |

VEGANE

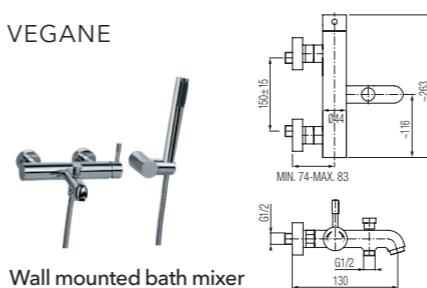

Wall mounted bath mixer

| | |
|--------------------|---------|
| Code: Chrome | 2422890 |
| Code: Bianco | 2423380 |
| Code: Nero | 2423390 |
| Cartridge | Ø35 |
| Flow class | S/A |
| Hoses / Connection | G 1/2 |
| Net weight | 2707 g |

VEGANE

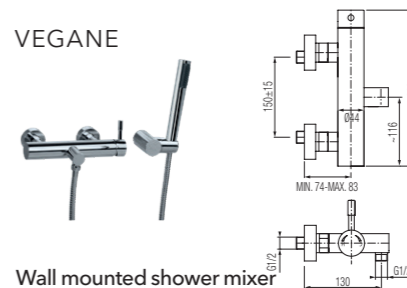

Wall mounted shower mixer

| | |
|--------------------|---------|
| Code: Chrome | 2422870 |
| Code: Bianco | 2423360 |
| Code: Nero | 2423370 |
| Cartridge | Ø35 |
| Flow class | A |
| Hoses / Connection | G 1/2 |
| Net weight | 2584 g |

LOFT ECO



Washbasin mixer

| | | |
|--------------------|---------|---------|
| Code: Chrome | 2454900 | 2454901 |
| Code: Black | 2455900 | --- |
| Code: White | 2456500 | --- |
| Code: Gold | 2455800 | --- |
| Cartridge | Ø35 | |
| Flow class | Z | |
| Hoses / Connection | G 3/8 | G 1/2 |
| Net weight | 1217 g | |

LOFT

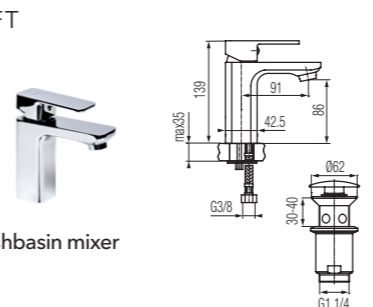

Washbasin mixer

| | | |
|--------------------|---------|---------|
| Code: Chrome | 2454910 | 2454911 |
| Cartridge | Ø35 | |
| Flow class | A | |
| Hoses / Connection | G 3/8 | G 1/2 |
| Net weight | 1217 g | |

LOFT

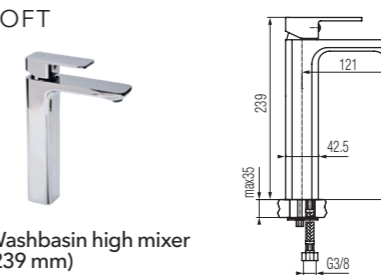

Washbasin high mixer (239 mm)

| | | |
|--------------------|---------|---------|
| Code: Chrome | 2454920 | 2454921 |
| Cartridge | Ø35 | |
| Flow class | Z | |
| Hoses / Connection | G 3/8 | G 1/2 |
| Net weight | 1545 g | |

LOFT

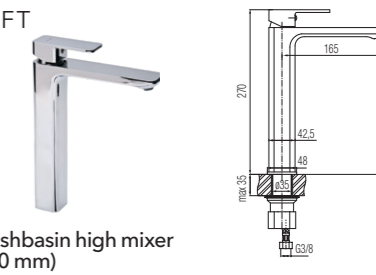

Washbasin high mixer (270 mm)

| | |
|--------------------|---------|
| Code: Chrome | 2454730 |
| Code: Black | 2455910 |
| Code: White | 2456510 |
| Cartridge | Ø35 |
| Flow class | Z |
| Hoses / Connection | G 3/8 |
| Net weight | 1652 g |

LOFT

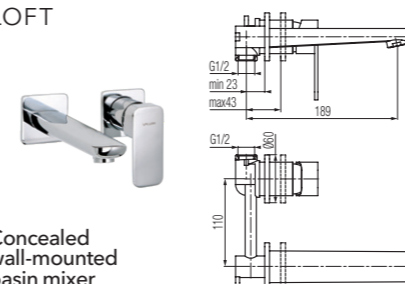

Concealed wall-mounted basin mixer

| | |
|--------------------|---------|
| Code: Chrome | 2454780 |
| Cartridge | Ø35 |
| Flow class | A |
| Hoses / Connection | G1/2 |
| Net weight | 1491 g |

LOFT



Four hole bath mixer

| | |
|--------------------|---------|
| Code: Chrome | 2454890 |
| Code: Black | 2455950 |
| Code: White | 2456550 |
| Cartridge | Ø35 |
| Flow class | B/Z |
| Hoses / Connection | G 3/8 |
| Net weight | 4180 g |

LOFT

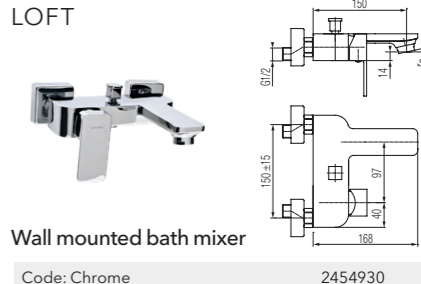

Wall mounted bath mixer

| | |
|--------------------|---------|
| Code: Chrome | 2454930 |
| Code: Black | 2455920 |
| Code: White | 2456520 |
| Code: Gold | 2455810 |
| Cartridge | Ø35 |
| Flow class | B/B |
| Hoses / Connection | G 1/2 |
| Net weight | 1847 g |

LOFT



Wall mounted shower mixer

| | |
|--------------------|---------|
| Code: Chrome | 2454940 |
| Code: Black | 2455930 |
| Code: White | 2456530 |
| Code: Gold | 2455810 |
| Cartridge | Ø35 |
| Flow class | B |
| Hoses / Connection | G 1/2 |
| Net weight | 1305 g |

LOFT

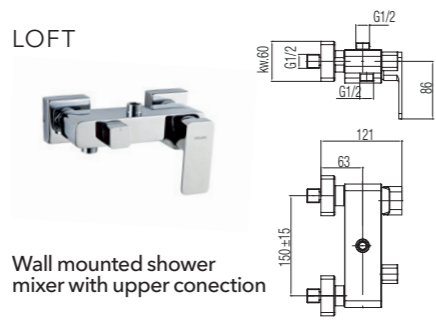

Wall mounted shower mixer with upper conection

| | |
|--------------------|---------|
| Code: Chrome | 2455760 |
| Cartridge | Ø35 |
| Flow class | A/A |
| Hoses / Connection | G 1/2 |
| Net weight | 1520 g |

LOFT

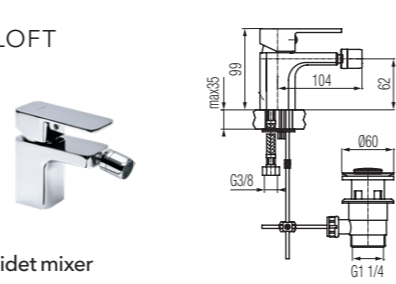

Bidet mixer

| | | |
|--------------------|---------|---------|
| Code: Chrome | 2454950 | 2454951 |
| Code: Black | 2455940 | --- |
| Code: White | 2456540 | --- |
| Cartridge | Ø35 | |
| Flow class | Z | |
| Hoses / Connection | G 3/8 | G 1/2 |
| Net weight | 1242 g | |

TUBE



Wall mounted shower mixer

| | |
|--------------------|---------|
| Code: Chrome | 2454840 |
| Cartridge | Ø35 |
| Flow class | B |
| Hoses / Connection | G 1/2 |
| Net weight | 1075 g |

TUBE

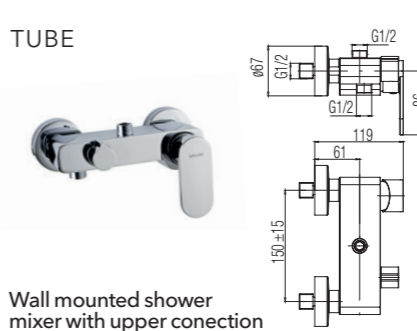

Wall mounted shower mixer with upper conection

| | |
|--------------------|---------|
| Code: Chrome | 2455720 |
| Cartridge | Ø35 |
| Flow class | A/A |
| Hoses / Connection | G 1/2 |
| Net weight | 1490 g |

TUBE

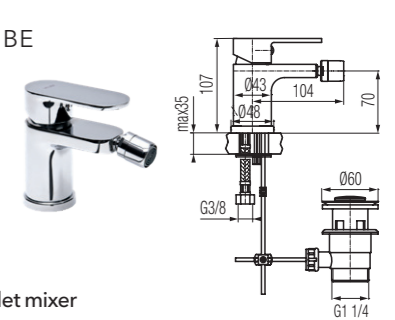

Bidet mixer

| | | |
|--------------------|---------|---------|
| Code: Chrome | 2454850 | 2454830 |
| Cartridge | Ø35 | |
| Flow class | Z | |
| Hoses / Connection | G 3/8 | G 1/2 |
| Net weight | 1137 g | |

LOFT

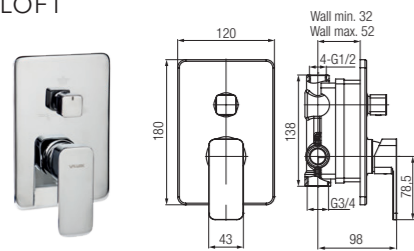

3-function concealed mixer

| | |
|--------------------|--------------|
| Code: Chrome | 2408660 |
| Cartridge | Ø35 |
| Flow class | B/B/B |
| Hoses / Connection | G 1/2 x G3/4 |
| Net weight | 1585 g |

TUBE ECO



Washbasin mixer

| | | |
|--------------------|---------|---------|
| Code: Chrome | 2454800 | 2454801 |
| Cartridge | Ø35 | |
| Flow class | Z | |
| Hoses / Connection | G 3/8 | G 1/2 |
| Net weight | 920 g | |

TUBE



Washbasin mixer

| | | |
|--------------------|---------|---------|
| Code: Chrome | 2454810 | 2454811 |
| Cartridge | Ø35 | |
| Flow class | A | |
| Hoses / Connection | G 3/8 | G 1/2 |
| Net weight | 920 g | |

TUBE

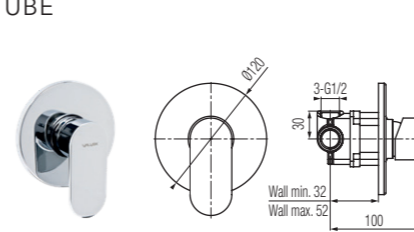

Concealed shower mixer

| | |
|--------------------|---------|
| Code: Chrome | 2454870 |
| Cartridge | Ø35 |
| Flow class | A |
| Hoses / Connection | G 1/2 |
| Net weight | 1075 g |

TUBE

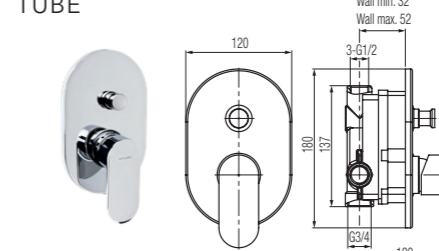

Concealed bathtub and shower mixer tap

| | |
|--------------------|--------------------------------|
| Code: Chrom | 2454880 |
| Cartridge | Ø35 |
| Flow class | B/B |
| Hoses / Connection | in 2-G 1/2, out 1-G1/2, 1-G3/4 |
| Net weight | 1447 g |

TUBE

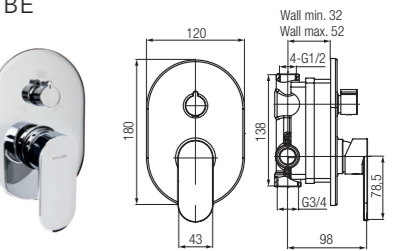

3-function concealed mixer

| | |
|--------------------|--------------|
| Code: Chrome | 2408640 |
| Cartridge | Ø35 |
| Flow class | B/B/B |
| Hoses / Connection | G 1/2 x G3/4 |
| Net weight | 1513 g |

TUBE

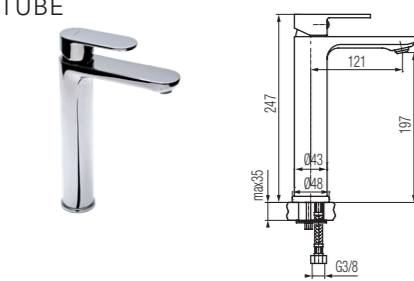

Washbasin high mixer

| | | |
|--------------------|---------|---------|
| Code: Chrome | 2454820 | 2454830 |
| Cartridge | Ø35 | |
| Flow class | Z | |
| Hoses / Connection | G 3/8 | G 1/2 |
| Net weight | 1300 g | |

TUBE



Concealed wall-mounted basin mixer

| | |
|--------------------|---------|
| Code: Chrome | 2454790 |
| Cartridge | Ø35 |
| Flow class | A |
| Hoses / Connection | G1/2 |
| Net weight | 1271 g |

TUBE

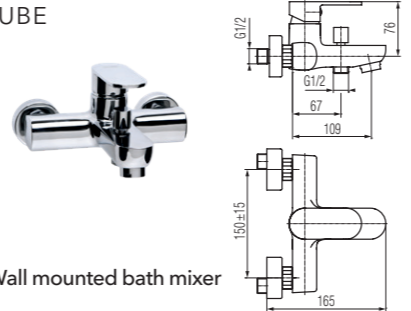

Wall mounted bath mixer

| | |
|--------------------|---------|
| Code: Chrome | 2454830 |
| Cartridge | Ø35 |
| Flow class | B/B |
| Hoses / Connection | G 1/2 |
| Net weight | 1410 g |

SIGMA

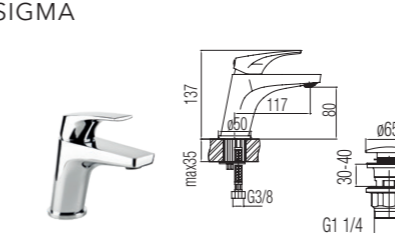

Washbasin mixer

| | |
|--------------------|---------|
| Code: Chrome | 2456100 |
| Cartridge | Ø35 |
| Flow class | Z |
| Hoses / Connection | G 3/8 |
| Net weight | 1260 g |

SIGMA

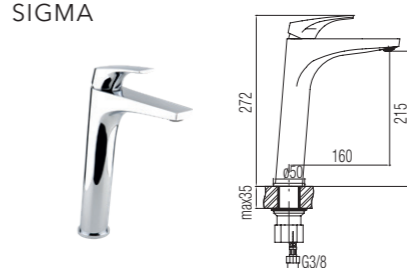

Washbasin high mixer

| | |
|--------------------|---------|
| Code: Chrome | 2456140 |
| Cartridge | Ø35 |
| Flow class | Z |
| Hoses / Connection | G 3/8 |
| Net weight | 1640 g |

SIGMA

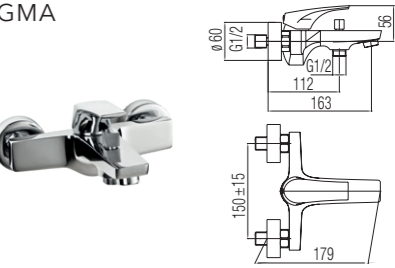

Wall mounted bath mixer

| | |
|--------------------|---------|
| Code: Chrome | 2456110 |
| Cartridge | Ø35 |
| Flow class | A/B |
| Hoses / Connection | G 1/2 |
| Net weight | 1480 g |



VALVEX SA

ul. Nad Skawą 2
34-240 Jordanów
POLAND

tel.: +48 18 269 32 20
mail: valvex@valvex.com
www.valvex.com

9999527
release date: 08.2019